

Basic version

Pos	Qty	Part nr	Robot nr	Description		Pattern	Material
1	1	706297	R703-352-RM	Pump shaft	IEC160/225		AISI 304
5	1	9L0390	R750-057	Ball bearing	6310-2Z		
	(1)	9L1110	R750-101	Ang. contact ball bearing	3310-2Z IEC200/225		
6	1	9L0390	R750-057	Ball bearing	6310-2Z		
10	1	706298	R704-193-GG	Seal housing	BW/BD60	P4018	EN-GJL-250
11	1	706299	R704-194-GG	Seal housing	-2 BW60	P4019	EN-GJL-250
12	1	9D2271	R706-301	Mechanical seal	Ø50 NBR/ceramic/SiC/1.457		SiC/ceramic/NBR
13	1	9D2270	R706-300	Mechanical seal	Ø50 NBR / SiC/SiC / 1.4571		SiC/SiC/NBR
14	1	9D1131	R706-334	Lip seal	OBC 050.065.10-11		
15	1	706213	R707-189-GG	Bearing housing	Ø110 IEC132/180	P4016	EN-GJL-250
16	1	706206	R707-209-GG	Bearing housing cover	IEC132/180	P4001	EN-GJL-250
18	1	706246	R707-084-ST	Distance ring	IEC100-180		S235JR
35	1	706234	R716-071-RV	Oil tank			AISI 304
36	1	706210	R716-086	Filling plug			
	1	9B5320	R756-137	Plug	G 1"		PA 66
39	1	706235	R716-072	Bracket	-H		S235JR
41	2	706233	R716-043	Coupling	RIK 8x1/4"		CuZn 40
42	2	706233	R716-043	Coupling	RIK 8x1/4"		CuZn 40
43	2	9M5530	R716-031	Pipe	Ø8 L=100mm		Cu
45	2	9B4423	R754-141	Hexagon socket screw	M 6 x 20		AISI 316
46	2	9B4423	R754-141	Hexagon socket screw	M 6 x 20		AISI 316
47	2	9B4722	R758-088	Lock washer	(M 6)		AISI 316
48	2	9B3803	R755-077	Nut	M 6		AISI 316
49	1	706280	R716-091	Pipe nipple	R1/4"x100		Fe galv.
50	1	9F2502	R716-092	Socket	R1/4"		Fe galv.
51	1	9B5420	R756-139	Plug	R 1/4"		AISI 316
56	1	77256Z	R713-259-RZ	Data plate	Blanco 87x45x1		
60	1	9D1335	R751-032	O-ring	104.5x 3.00		NBR
66	1	9B1850	R752-006	Circlip	A 50x2		spring steel
67	1	9B1850	R752-006	Circlip	A 50x2		spring steel
68	1	9B1870	R752-033	Circlip	J110x4		spring steel
69	1	9B1850	R752-006	Circlip	A 50x2		spring steel
74	8	9B4455	R754-170	Hexagon socket screw	M12x 45		AISI 316
77	4	9B4451	R754-183	Hexagon socket screw	M12x 25		AISI 316
78	4	9B4454	R754-164	Hexagon socket screw	M12x 40		AISI 316
82	1	9B2332	R756-012	Key	12x 8x50		AISI 316
83	1	9B2316	R756-125	Key	10x 8x30		AISI 316
87	4	9B4202	R757-076	Data plate rivet	2.9x6.5		AISI 316
96	1	9S0033	R906-069	Oil	Shell Tellus 32 2 ltr		
101	1	706300	R701-232-GG	Volute	RW6141/BW6141	P4020	EN-GJL-250
107	1	706279	R712-161-ST	Reducer flange	R100-NW100		S235JR
	(1)		R712-214-ST	Reducer flange	R100-4" ANSI 150		
	(1)	76497S	R712-193-ST	Reducer flange	R100-NW150 PN10/PN16		S235JR
112	1	9B5310	R709-325	Plug	G 3/8"		CuZn 40
113	1	9B5310	R709-325	Plug	G 3/8"		CuZn 40

Pos	Qty	Part nr	Robot nr	Description		Pattern	Material
114	1	706231	R713-175	Seal ring	A 17x23x1.5 plug G3/8"		Cu
115	1	706231	R713-175	Seal ring	A 17x23x1.5 plug G3/8"		Cu
118	1	9D1384	R751-122	O-ring	345x 5.00		NBR
124	8	9B4459	R754-192	Hexagon socket screw	M16x 45		AISI 316
128	4	9B4455	R754-170	Hexagon socket screw	M12x 45		AISI 316
131	4	9B3806	R755-091	Nut	M12		AISI 316
137	1	706282	R761-002	Gasket	140xØ105x2		CR
138	1	706304	R760-139	Gasket	Ø190xØ125x3		CR
140	1	706302	R708-377-NG H	Impeller	RW6141/6111 con50	P4021	EN-GJS-400-15
	(1)		R708-377-NG-3	Impeller	360 RW6141/6111 con50		
	(1)		R708-377-NG-3	Impeller	340 RW6141/6111 con50		
	(1)		R708-377-NG-3	Impeller	335 RW6141/6111 con50		
	(1)		R708-377-NG-3	Impeller	315 RW6141/6111 con50		
	(1)		R708-377-NG-3	Impeller	300 RW6141/6111 con50		
	(1)		R708-377-NG-2	Impeller	295 RW6141/6111 con50		
	(1)		R708-377-NG-2	Impeller	285 RW6141/6111 con50		
	(1)		R708-377-NG-2	Impeller	275 RW6141/6111 con50		
	(1)		R708-377-NG-2	Impeller	270 RW6141/6111 con50		
	(1)		R708-377-NG-2	Impeller	265 RW6141/6111 con50		
	(1)		R708-377-NG-2	Impeller	255 RW6141/6111 con50		
	(1)		R708-377-NG-2	Impeller	250 RW6141/6111 con50		
	(1)		R708-377-NG-2	Impeller	245 RW6141/6111 con50		
	(1)		R708-377-NG-2	Impeller	225 RW6141/6111 con50		
	(1)		R708-377-NG-2	Impeller	200 RW6141/6111 con50		
	(1)		R708-377-NG-1	Impeller	180 RW6141/6111 con50		
141	1	706305	R713-160-RZ	Impeller hubcap	Ø44x13.5x8		AISI 316
145	1	9B0645	R754-203	Hex. sock. screw counter sunk.	M12x 55		AISI 316
230	1	706303	R710-405-ST	Volute support	H BT20/4040 BWP62-41 hh280		S235JR
	(1)		R710-483-ST	Volute support	H BT BWP62-41 (ANSI 150) hh280		
231	1	706224	R710-402-ST	Volute support	-2 BW BWP		S235JR
232	6	9B4441 repl	R754-027	Hexagon socket screw	M10x 25		
233	2	9B4462	R754-215	Hexagon socket screw	M16x 30		AISI 316
234	2	9B3907 repl	R758-084	Washer	(M16)		
235	2	9B3807 repl	R755-086	Nut	M16		
240	1	706226	R710-411-ST	Bearing housing support	40/60/62 (GP) hh280		S235JR
242	2	9B4451	R754-183	Hexagon socket screw	M12x 25		AISI 316
<b>Supplement frame, motors and v-belt options</b>							
300	(1)	706218	R710-390-ST	Frame	BW-K IEC100/180		S235JR
	(1)	706222	R710-395-ST	Frame	BW-K IEC200/225		S235JR
301	(1)	9T2020	R713-157	Tensioning rail	W600/10 IEC 100/132		
	(1)	9T2021	R713-158	Tensioning rail	G180/12 IEC 160/180		
	(1)	9T2022	R713-180	Tensioning rail	G225/16 IEC200/225		
304.1	2	9T0640	R713-191	Clamping profile	14.5x10		EPDM
304.2	4	706237	R710-451	Mounting plate	Z		S235JR
304	(2)	706229	R710-518	Mounting plate	Z-profiel		S235JR
305	(2)	706215	R710-269	Protecting shield	BW-K IEC100-180		S235JR

Pos	Qty	Part nr	Robot nr	Description	Pattern	Material
305	(2)	706223	R710-396	Protecting shield	BW-K IEC200-225	S235JR
306	(1)		R713-138	Grip bush	Ø 28 IEC 100/112 Sn140	
	(1)	9T0628	R713-142	Grip bush	Ø 28 IEC 100/112 Sn150/224	
	(1)	9T0630	R713-140	Grip bush	Ø 38 IEC 132 Sn140	
	(1)	9T0629	R713-144	Grip bush	Ø 38 IEC 132 Sn150/224	
	(1)	9T0635	R713-174	Grip bush	Ø 42 IEC 160 Sn140	
307	(1)	9T0631	R713-145	Grip bush	Ø 42 IEC 160 Sn150/224	
	(1)	9T0634	R713-148	Grip bush	Ø 42 IEC 160 Sn250/355	
	(1)	9T0632	R713-146	Grip bush	Ø 48 IEC 180 Sn150/224	
	(1)	9T0635	R713-174	Grip bush	Ø 42 IEC 160 Sn140	
	(1)	9T0631	R713-145	Grip bush	Ø 42 IEC 160 Sn150/224	
	(1)	9T0634	R713-148	Grip bush	Ø 42 IEC 160 Sn250/355	
	(1)	9T0633	R713-147	Grip bush	Ø 55 IEC 200 Sn150/224	
	(1)	9T0636	R713-193	Grip bush	Ø 60 IEC 225S Sn250/355	
308	(1)	9T0600	R713-129	Pulley	Ø140, SPB 17 art. nr. ZA000521	
	(1)	9T0610	R713-197	Pulley	Ø150, SPB 17 art.nr. ZA000522	
	(1)	9T0601	R713-130	Pulley	Ø160, SPB 17 art. nr. 00041172	
	(1)	9T0602	R713-131	Pulley	Ø180, SPB 17 art. nr. 00041175	
	(1)	9T0603	R713-132	Pulley	Ø200, SPB 17 art. nr. ZA000523	
309	(1)	9T0600	R713-129	Pulley	Ø140, SPB 17 art. nr. ZA000521	
	(1)	9T0601	R713-130	Pulley	Ø160, SPB 17 art. nr. 00041172	
	(1)	9T0602	R713-131	Pulley	Ø180, SPB 17 art. nr. 00041175	
	(1)	9T0603	R713-132	Pulley	Ø200, SPB 17 art. nr. ZA000523	
	(1)	9T0604	R713-133	Pulley	Ø224, SPB 17 art.nr. 00041173	
	(1)	9T0605	R713-134	Pulley	Ø250, SPB17 art.nr. 00041174	
	(1)	9T0606	R713-135	Pulley	Ø280, SPB 17 art. nr. 0040888	
	(1)	9T0607	R713-198	Pulley	Ø300, SPB 17 art.nr. 00041171	
	(1)	9T0608	R713-136	Pulley	Ø315, SPB 17 art. nr. ZA000510	
	(1)	9T0609	R713-137	Pulley	Ø355, SPB 17 art.nr. ZA000509	
310	(3)	9T0650	R713-103	V-belt	LW 1600	
	(3)	9T0651	R713-104	V-belt	LW 1700	
	(3)	9T0652	R713-105	V-belt	LW 1800	
	(3)	9T0654	R713-106	V-belt	LW 1900	
	(3)	9T0653	R713-107	V-belt	LW 2000	
311	(2)	706221	R710-393-ST	Mounting plate	IEC100-180	S235JR
312	(2)	706219	R710-391-ST	Mounting plate	IEC100-132	S235JR
	(2)	706220	R710-392-ST	Mounting plate	IEC160/180	S235JR
313	(4)	9B4454	R754-164	Hexagon socket screw	M12x 40	AISI 316
	(4)	9B4459	R754-192	Hexagon socket screw	M16x 45	AISI 316
	(4)	9B4462	R754-102	Hexagon socket screw	M16x 30	
314	14	9B1420	R757-090	Tapping screw	5.5x19	Fe galv.
315	(4)	9B4725	R758-091	Lock washer	(M12)	AISI 316
	(4)	9B4726	R758-082	Lock washer	(M16)	AISI 316
	(4)	9B3908	R758-100	Washer	(M20)	AISI 316
316	(4)	9B3906	R758-102	Washer	(M12)	AISI 316
	(4)	9B3907	R758-103	Washer	(M16)	AISI 316
	(4)	9B3908	R758-100	Washer	(M20)	AISI 316

Pos	Qty	Part nr	Robot nr	Description	Pattern	Material
317	(4)	9B3806	R755-091	Nut	M12	AISI 316
	(4)	9B3807	R755-093	Nut	M16	AISI 316
	(4)	9B3808	R755-094	Nut	M20	AISI 316
318	(4)	9B3110	R753-185	Hexagon-head bolt	M10x 50	AISI 316
	(4)	9B3120	R753-182	Hexagon-head bolt	M12x 55	AISI 316
	(4)		R753-250	Hexagon-head bolt	M16x 90	
319	(4)	9B3805	R755-097	Nut	M10	AISI 316
	(4)	9B3806	R755-091	Nut	M12	AISI 316
	(4)	9B3807	R755-093	Nut	M16	AISI 316
320	(4)	9B3905	R758-097	Washer	(M10)	AISI 316
	(4)	9B3906	R758-102	Washer	(M12)	AISI 316
	(4)	9B3907	R758-103	Washer	(M16)	AISI 316
400	(1)	IEC100L 3.0-4B3	R790-002	Motor	IEC100L 3 kW-4 voet B3	
	(1)	IEC112M 4.0-4B3	R790-003	Motor	IEC112M 4 kW-4 voet B3	
	(1)	IEC132S 5.5-4B3	R790-004	Motor	IEC132S 5.5 kW-4 voet B3	
	(1)	IEC132M 7.5-4B3	R790-005	Motor	IEC132M 7.5 kW-4 voet B3	
	(1)	IEC160M 11.0-4B3	R790-006	Motor	IEC160M 11 kW-4 voet B3	
	(1)	IEC160L 15.0-4B3	R790-007	Motor	IEC160L 15 kW-4 voet B3	
	(1)	IEC160M 18.5-4B3	R790-041	Motor	IEC180M 18.5kW-4 voet B3	
	(1)	IEC160M 22-4B3	R790-042	Motor	IEC180L 22kW-4 voet B3	
	(1)	IEC200L 30-4B3	R790-061	Motor	IEC200L 30kW-4 voet B3	
	(1)	IEC225S 37-4B3	R790-053	Motor	IEC225S 37 kW-4 voet B3	
<b>Option Sparepart kit</b>						
600	1	77887E	R506-7002	Spare part kit	BW3/5/6000-HV/K IEC>=200	

BW6041-K

Dwg : 593 N1  
Date : 031997  
Page : 1/2  
By : PZ  
Repl. : .

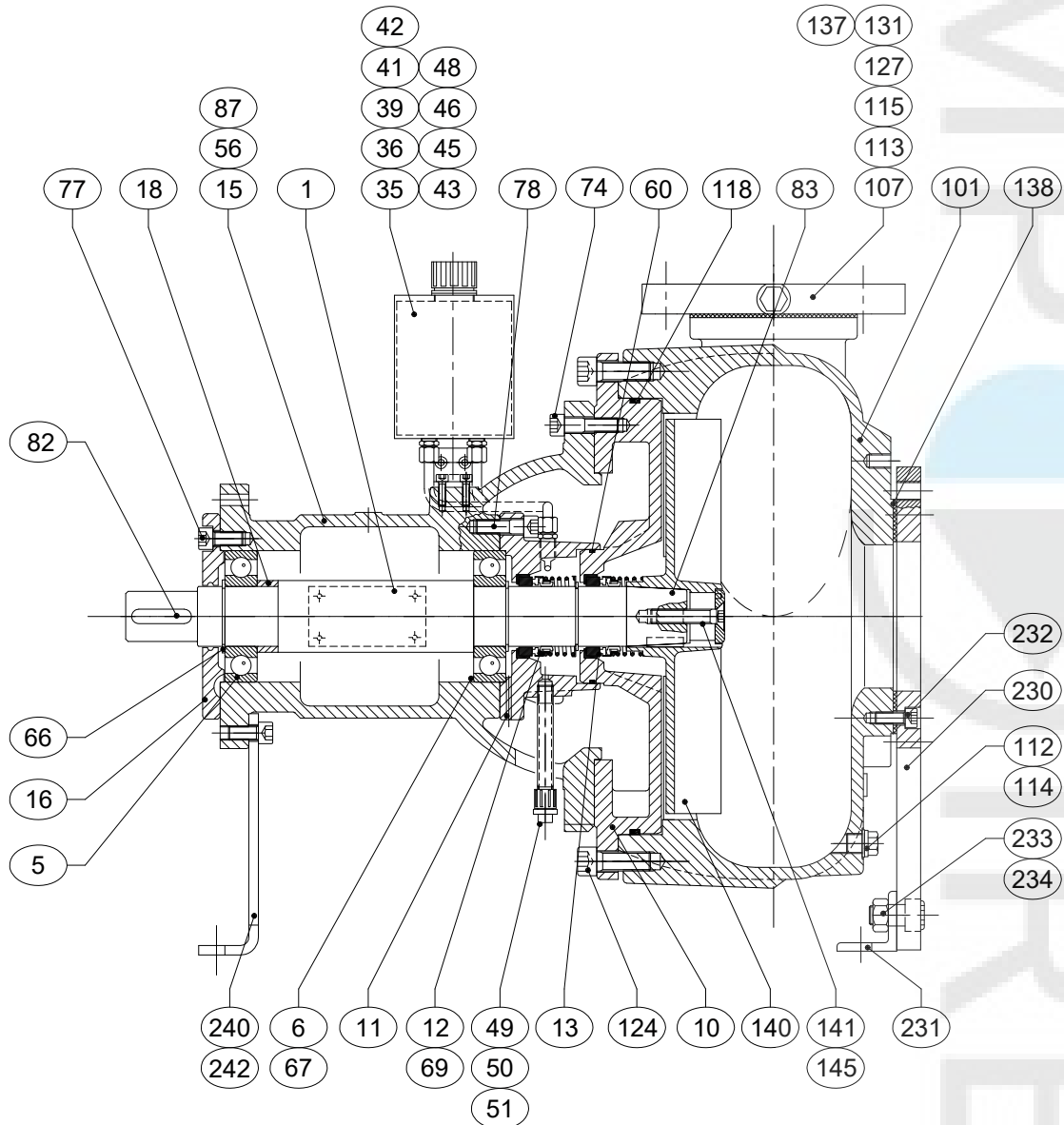

BW6041-K

Dwg : 593 N1

Date : 031997

Page : 2/2

By : PZ

Repl. : .

