

BW6000

Code: 108.02

 Partslist no.: 115P2
 Date : 01-1985
 Dwg. no. : 115N5
 Replace :

Basic version

Pos	Qty	Part nr	Robot nr	Description		Pattern	Material
1	1	706211	R703-117-RM	Pump shaft	Ø35/42		AlSi 431
2	1		R704-111-GG	Seal housing	BW4000hp/6000		
3	2	9D1135	R706-079	Lip seal	BA 50x80x10		
4	1	706212	R706-084-RD	Seal sleeve	Ø40/Ø50		AlSi 303
5	1	9D2265	R706-277	Mechanical seal	Ø50 primair		SiC/SiC/NBR
6	1	9D1130	R706-215	Lip seal	BA 45x60x7		
7	1	9L6430	R706-216	Seal sleeve	IR40x45x20		
8	2	76484G	R707-071-GG	Bearing housing cover	Ø110	P4001	EN-GJL-250
9	1		R707-083-GG	Bearing housing	Ø110/Ø110 -H		
10	1	706246	R707-084-ST	Distance ring	IEC100-180		S235JR
11	1	9B1720	R709-127	Plug	G 3/8" Nr. 290		Fe galv.
13	1	706200	R713-177-RZ	Data plate	BW/BT/BD BWP/BNP		AlSi 316
15	1	9B1720	R709-127	Plug	G 3/8" Nr. 290		Fe galv.
16	2	706233	R716-043	Coupling	RIK 8x1/4"		CuZn 40
17	2		R750-097	Ball bearing	6310		
18	1	9D1273	R751-002	O-ring	39.69x 3.53		NBR
19	2	9B1850	R752-006	Circlip	A 50x2		spring steel
20	1	9B1870	R752-033	Circlip	J110x4		spring steel
21	6	9B4431	R754-155	Hexagon socket screw	M 8x 25		AlSi 316
22	6	9B4431	R754-155	Hexagon socket screw	M 8x 25		AlSi 316
23	8	9B4455 repl	R754-135	Hexagon socket screw	M12x 45 BW6000		
24	1	9B2318	R756-106	Key	10x 8x50		AlSi 316
25	1	9B2332	R756-012	Key	12x 8x50		AlSi 316
26	4	9B4202	R757-076	Data plate rivet	2.9x6.5		AlSi 316
27	2	76115W	R760-099	Gasket	Ø145xØ110x0.4		Klingerseal
29	2	9S3001	R756-079	Grease nipple	R1/8 recht		Cu/Zn40
70	1	9M5530	R716-031	Pipe	Ø8 L=100mm		Cu
71	1	9M5530	R716-031	Pipe	Ø8 L=100mm		Cu
72	2	706233	R716-043	Coupling	RIK 8x1/4"		CuZn 40
73	1	706234	R716-071-RV	Oil tank			AlSi 304
74	1		R713-074	Oil level glass	R3/4"		
75	1		R716-057	Filling plug	Turbo Oxydeur		
76	1	706235	R716-072	Bracket	-H		S235JR
77	2	9B4423 repl	R754-082	Hexagon socket screw	M 6 x 20		
78	2	9B4423 repl	R754-082	Hexagon socket screw	M 6 x 20		
79	2	9B3803 repl	R755-032	Nut	M 6		
80	2	9B4722 repl	R758-079	Lock washer	(M 6)		
81	2	9B4722 repl	R758-079	Lock washer	(M 6)		
101	1	706202	R701-092-GG	Volute	BW/BWV6000 NW200	P4007	EN-GJL-250
102	1	W06207	R708-311-NG	Impeller	RW6062/HW6000 Ø35	P4006	EN-GJS-400-15
103	1		R708-073-MS	Impeller hubcap	Ø39,7x14x22		
106	2		R709-057	Plug	G 1/2" Nr. 290		

Pos	Qty	Part nr	Robot nr	Description	Pattern	Material
107	1	9B1720	R709-127	Plug	G 3/8" Nr. 290	Fe galv.
110	7	9B4456	R754-113	Hexagon socket screw	M12x 50	AISI 316
112	1	9B4454 repl	R754-111	Hexagon socket screw	M12x 40	
116	1	9B4725	R758-074	Lock washer	(M12)	
117	1		R760-108	Gasket	Ø435xØ340x0.4	
Supplement support horizontal installation						
105	1		R710-312-ST	Bearing housing support	H hh280	
	(1)		R710-275-ST	Bearing housing support	H (GP) hh280	
108	1		R710-311-ST	Volute support	H BW4000hp/6000 hh280	
	(1)	706217	R710-272-ST	Volute support	H BW6000 BWP60-60 (GP) hh280	S235JR
109	2	9B4454 repl	R754-111	Hexagon socket screw	M12x 40	
111	4	9B4451 repl	R754-112	Hexagon socket screw	M12x 25	
113	2	9B3806 repl	R755-083	Nut	M12	
114	2	9B4725	R758-074	Lock washer	(M12)	
Supplement Found. plate, coupling and motor IEC160/180						
203	(1)	76347S	R710-288-ST	Motor support	IEC160 hh280	S235JR
	(1)	76348S	R710-291-ST	Motor support	IEC180 hh280	S235JR
	(1)	77166S	R710-294-ST	Motor support	IEC200 hh280	S235JR
	(1)	76350S	R710-296-ST	Motor support	IEC250 hh280	S235JR
204	(1)		R710-206	Protecting hood	IEC160/180	
	(1)		R710-118	Protecting hood	IEC 200	
208	(4)	9B3055	R753-101	Hexagon tap bolt	M12x 40	AISI 316
	(4)		R753-130	Hexagon-head bolt	M16x 60	
	(4)	9B3141	R753-165	Hexagon-head bolt	M20x 80	AISI 316
209	4		R753-156	Hexagon tap bolt	M 8x 20	
214	(4)	9B3806 repl	R755-083	Nut	M12	
	(4)	9B3807 repl	R755-086	Nut	M16	
	(4)	9B3808 repl	R755-078	Nut	M20	
216	4	9B4725	R758-074	Lock washer	(M12)	
217	(4)	9B4725	R758-074	Lock washer	(M12)	
	(4)	9B4726	R758-082	Lock washer	(M16)	AISI 316
	(4)		R758-093	Washer	(M20)	
Option: seal flushing						
30	1		R711-131-GG	Baffle plate	BW3/4/5000	
31	1	706232	R716-029	Pipe nipple	R3/8 x 150	AISI 316
32	1		R716-045	Flow indicator		
33	3	9B4430 repl	R754-077	Hexagon socket screw	M 8x 20	
34	3	9B4723	R758-077	Lock washer	(M 8)	

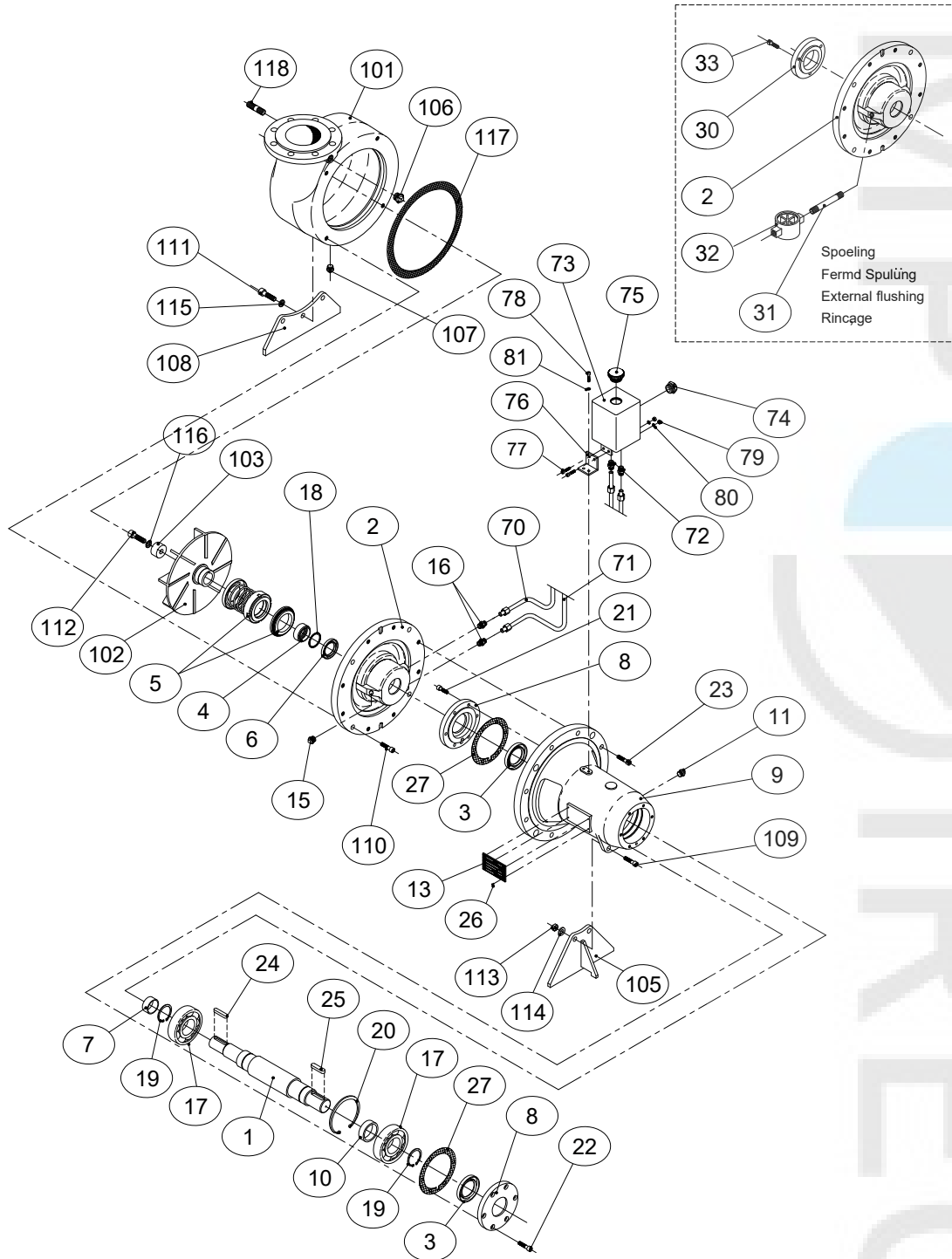

BW

