

Stainless steel version

Pos	Qty	Part nr	Robot nr	Description		Pattern	Material
1	1	76285Z	R703-351-RZ	Pump shaft	IEC132		AISI 316
5	1	9L0390	R750-057	Ball bearing	6310-2Z		
6	1	9L0390	R750-057	Ball bearing	6310-2Z		
10	1	76434U	R704-188-RZ	Seal housing	BW40/BD40 BWP/BNP42	P588U	AISI 329
11	1	706257	R704-192-GG	Seal housing	-2 BW40	P4012	EN-GJL-250
12	1	9D2266	R706-314	Mechanical seal	Ø35 NBR/ceramic/SiC/1.457		Carb/ceramic/NB
13	1	9D2269	R706-317	Mechanical seal	Ø30 Viton		SiC/SiC/FPM
14	1	9D1131	R706-334	Lip seal	OBC 050.065.10-11		
15	1	76449G	R707-304-GG	Bearing housing	BWP42-20/21HX-U Duplex	1331	EN-GJL-250
16	1	706206	R707-209-GG	Bearing housing cover	IEC132/180	P4001	EN-GJL-250
18	1	706246	R707-084-ST	Distance ring	IEC100-180		S235JR
35	1	706234	R716-071-RV	Oil tank			AISI 304
36	1	706210	R716-086	Filling plug			
	1	9B5320	R756-137	Plug	G 1"		PA 66
39	1	706235	R716-072	Bracket	-H		S235JR
41	2	706233	R716-043	Coupling	RIK 8x1/4"		CuZn 40
42	2	706233	R716-043	Coupling	RIK 8x1/4"		CuZn 40
43	2	9M5530	R716-031	Pipe	Ø8 L=100mm		Cu
45	2	9B4423	R754-141	Hexagon socket screw	M 6 x 20		AISI 316
46	2	9B4423	R754-141	Hexagon socket screw	M 6 x 20		AISI 316
47	2	9B4722	R758-088	Lock washer	(M 6)		AISI 316
48	2	9B3803	R755-077	Nut	M 6		AISI 316
49	1	706280	R716-091	Pipe nipple	R1/4"x100		Fe galv.
50	1	9F2502	R716-092	Socket	R1/4"		Fe galv.
51	1	9B5420	R756-139	Plug	R 1/4"		AISI 316
56	1	77256Z	R713-259-RZ	Data plate	Blanco 87x45x1		
60	1	9D1320	R751-207	O-ring	66x 3.00		NBR
66	1	9B1850	R752-006	Circlip	A 50x2		spring steel
67	1	9B1850	R752-006	Circlip	A 50x2		spring steel
68	1	9B1870	R752-033	Circlip	J110x4		spring steel
69	1	9B1835	R752-004	Circlip	A 35x1.5		spring steel
74	8	9B4454	R754-164	Hexagon socket screw	M12x 40		AISI 316
77	4	9B4451	R754-183	Hexagon socket screw	M12x 25		AISI 316
78	4	9B4451	R754-183	Hexagon socket screw	M12x 25		AISI 316
82	1	9B2332	R756-012	Key	12x 8x50		AISI 316
83	1	9B2305	R756-101	Key	6 x 6x20		AISI 316
87	4	9B4202	R757-076	Data plate rivet	2.9x6.5		AISI 316
96	1	9S0033	R906-069	Oil	Shell Tellus 32 2 ltr		
101	1	76607Z	R701-192-RZ	Volute	RW2030/40 RW4030/40-R		AISI 316
107	1	76606Z	R712-184-RZ	Reducer flange	R100-NW100 PN10		AISI 316
	(1)		R712-214-RZ	Reducer flange	R100-4" ANSI 150		
112	1	9B5311	R756-132	Plug	G 3/8"		AISI 316
113	1	9B5311	R756-132	Plug	G 3/8"		AISI 316
114	1	77083L	R756-147	Seal ring	Ø17x24x2 plug G3/8"		PTFE
115	1	77083L	R756-147	Seal ring	Ø17x24x2 plug G3/8"		PTFE

Pos	Qty	Part nr	Robot nr	Description	Pattern	Material
118	1	9D1314	R751-176-VI	O-ring	249.3x 5.7	Viton
124	4	9B3719	R753-210	Stud bolt	M12 x 60	AISI 316
128	4	9B4455	R754-170	Hexagon socket screw	M12x 45	AISI 316
130	4	9B3806	R755-091	Nut	M12	AISI 316
131	4	9B3806	R755-091	Nut	M12	AISI 316
133	4	9B3906	R758-102	Washer	(M12)	AISI 316
137	1	77164F	R761-060-VI	Gasket	140xØ10x2 DWP/DNP22-30/31/40	FPM
138	1		R760-144	Gasket	Ø158xØ100x2	
140	1		R708-362-RZ	Impeller	RW4020/40/BW20 max 252 con30	
	(1)		R708-362-RZ-25	Impeller	250 RW4020/40/BW con30	
	(1)		R708-362-RZ-24	Impeller	240 RW4020/40/BW con30	
	(1)		R708-362-RZ-23	Impeller	230 RW4020/40/BW con30	
	(1)		R708-362-RZ-22	Impeller	225 RW4020/40/BW con30	
	(1)		R708-362-RZ-22	Impeller	220 RW4020/40/BW con30	
	(1)		R708-362-RZ-21	Impeller	215 RW4020/40/BW con30	
	(1)		R708-362-RZ-21	Impeller	210 RW4020/40/BW con30	
	(1)		R708-362-RZ-20	Impeller	205 RW4020/40/BW con30	
	(1)		R708-362-RZ-20	Impeller	200 RW4020/40/BW con30	
	(1)		R708-362-RZ-19	Impeller	195 RW4020/40/BW con30	
	(1)		R708-362-RZ-19	Impeller	190 RW4020/40/BW con30	
	(1)		R708-362-RZ-18	Impeller	185 RW4020/40/BW con30	
	(1)		R708-362-RZ-18	Impeller	185 RW4020/40/BW con30	
	(1)		R708-362-RZ-18	Impeller	180 RW4020/40/BW con30	
	(1)		R708-362-RZ-17	Impeller	175 RW4020/40/BW con30	
	(1)		R708-362-RZ-17	Impeller	173 RW4020/40/BW con30	
	(1)		R708-362-RZ-17	Impeller	170 RW4020/40/BW con30	
	(1)		R708-362-RZ-24	Impeller	240 RW4020/40/BW con30	
	(1)		R708-362-RZ-16	Impeller	165 RW4020/40/BW con30	
	(1)		R708-362-RZ-16	Impeller	160 RW4020/40/BW con30	
	(1)		R708-362-RZ-15	Impeller	150 RW4020/40/BW con30	
	(1)		R708-362-RZ-14	Impeller	140 RW4020/40/BW con30	
141	1	706261	R713-226-RU	Impeller hubcap	ø30xø9x4	AISI 329
145	1	706292	R754-117	Hex. sock. screw counter sunk.	M 8x 20	AISI 316
Supplement support horizontal installation						
230	1		R710-398-STR	Volute support	H BW NW100 hh225	
231	1	706224	R710-402-ST	Volute support	-2 BW BWP	S235JR
232	6	9B4441	R754-153	Hexagon socket screw	M10x 25	AISI 316
233	(2)	9B4462	R754-102	Hexagon socket screw	M16x 30	
234	(2)	9B3907 repl	R758-084	Washer	(M16)	
235	(2)	9B3807 repl	R755-086	Nut	M16	
240	1	706236	R710-412-ST	Bearing housing support	BWP42 hh225	S235JR
	(1)	706277	R710-413-ST	Bearing housing support	40 (GP) hh225	S235JR
242	2	9B4452 repl	R754-099	Hexagon socket screw	M12x 30	
Supplement Found. plate, coupling and motor IEC132/160						
304	(1)	9T0702	R710-335	Coupling	J-Flex Spacer 110-IEC132S+M Ø 38/42	

Pos	Qty	Part nr	Robot nr	Description		Pattern	Material
304	(1)	9T0703	R710-336	Coupling	J-Flex Spacer 150-IEC160M Ø 42/42		
	(1)	9T0700	R710-337	Coupling	J-Flex Spacer 190-IEC160L Ø 42/42		
305	(1)	76231S	R710-280-ST	Foundation plate	1250x560x110		S235JR
	(1)	706293	R710-281-ST	Foundation plate	1400x625x110		S235JR
309	(1)	76210S	R710-431-ST	Protecting hood	BW40/60/ BT40/60 L=325 IEC132		S235JR
	(1)	706295	R710-436-ST	Protecting hood	BW40/60/ BT40/60 L=355 IEC160/200		S235JR
310	(8)	9B3905	R758-101	Washer	(M10)		AISI 316
	(8)	9B3906	R758-102	Washer	(M12)		AISI 316
312	(4)	9B3046	R753-208	Hexagon tap bolt	M10x 40		AISI 316
	(4)	9B3057	R753-152	Hexagon-head bolt	M12x 50		AISI 316
313	(4)	9B3805	R755-097	Nut	M10		AISI 316
	(4)	9B3806	R755-091	Nut	M12		AISI 316
314	1	9B4496	R754-199	Hexagon socket screw	M12x 60		AISI 316
400	(1)	IEC132S 5.5-4B3	R790-004	Motor	IEC132S 5.5 kW-4 voet B3		
	(1)	IEC132M 7.5-4B3	R790-005	Motor	IEC132M 7.5 kW-4 voet B3		
	(1)	IEC132M 5.5-6B3	R790-109	Motor	IEC132M 5.5KW-6 -B3		
	(1)	IEC160M 11.0-4B3	R790-006	Motor	IEC160M 11 kW-4 voet B3		
	(1)	IEC160L 15.0-4B3	R790-007	Motor	IEC160L 15 kW-4 voet B3		
	(1)		R790-051	Motor	IEC132M 4 kW-6 voet B3		
401	(2)	76211S	R710-284-ST	Motor support	IEC132 hh225		S235JR
Option: seal flushing							
10	1	76238U	R704-188-RZ-F	Seal housing	BW/BD40 spoelw/flush	P588U	AISI 329
250	1	76239Z	R711-175-RZ	Baffle plate	BW40/BT20/4040		AISI 316
251	1	706232	R716-029	Pipe nipple	R3/8 x 150		AISI 316
252	3	9B4420	R754-184	Hexagon socket screw	M 6 x 12		AISI 316
Option Sparepart kit							
600	1	77884E	R506-7000	Spare part kit	BW40-H/V/K BWP/BNP42		

BW4040-H
BW4030-H

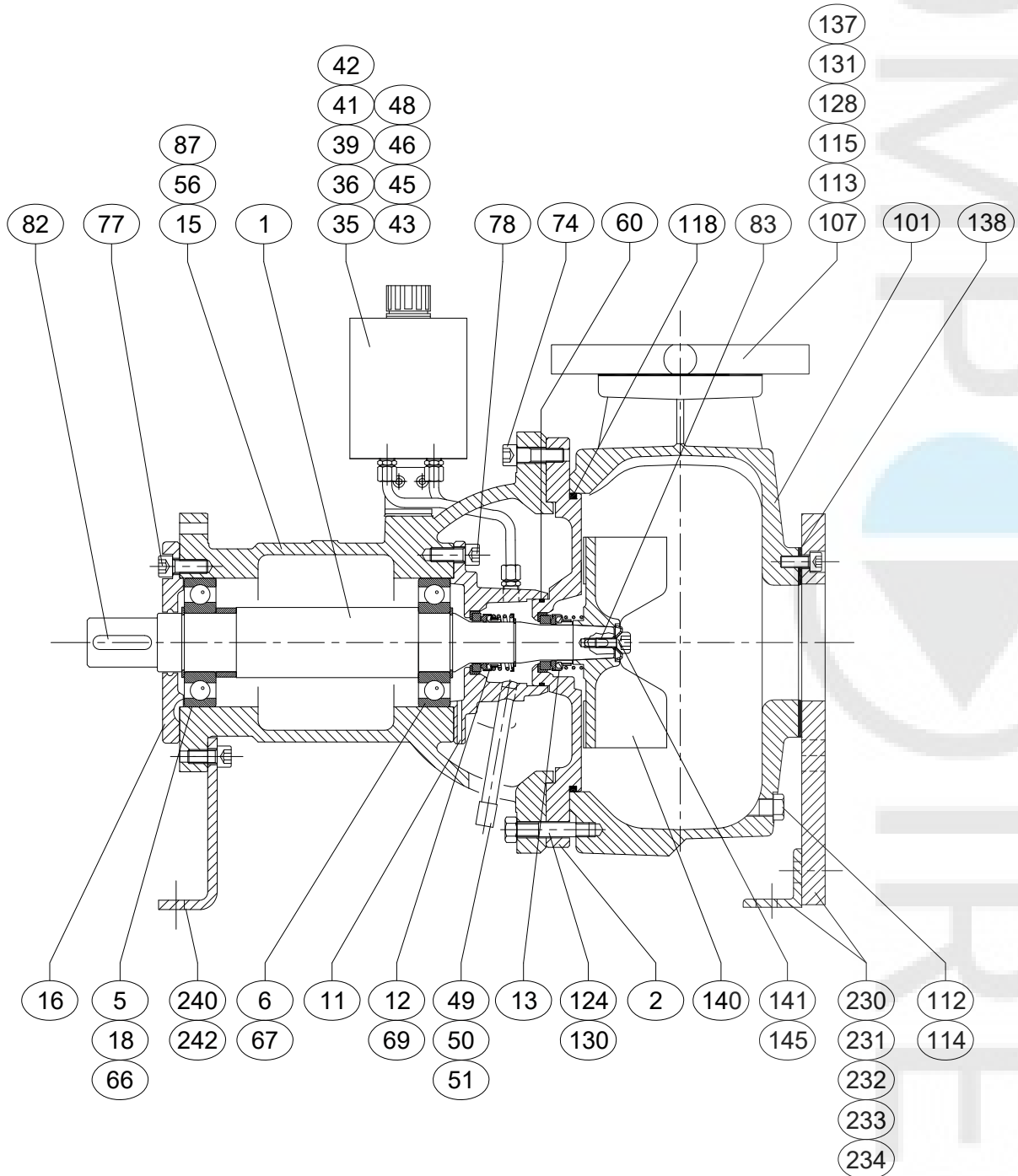

BW4040-HM
BW4030-HM

