

Stainless steel version

| Pos | Qty | Part nr | Robot nr | Description | | Pattern | Material |
|-----|-----|----------------|-------------|-----------------------|---------------------------|---------|-----------------|
| 1 | 1 | 76285Z | R703-351-RZ | Pump shaft | IEC132 | | AISI 316 |
| 5 | 1 | 9L0390 | R750-057 | Ball bearing | 6310-2Z | | |
| 6 | 1 | 9L0390 | R750-057 | Ball bearing | 6310-2Z | | |
| 10 | 1 | 76434U | R704-188-RZ | Seal housing | BW40/BD40 BWP/BNP42 | P588U | AISI 329 |
| 11 | 1 | 706257 | R704-192-GG | Seal housing | -2 BW40 | P4012 | EN-GJL-250 |
| 12 | 1 | 9D2266 | R706-314 | Mechanical seal | Ø35 NBR/ceramic/SiC/1.457 | | Carb/ceramic/NB |
| 13 | 1 | 9D2269 | R706-317 | Mechanical seal | Ø30 Viton | | SiC/SiC/FPM |
| 14 | 1 | 9D1131 | R706-334 | Lip seal | OBC 050.065.10-11 | | |
| 15 | 1 | 76449G | R707-304-GG | Bearing housing | BWP42-20/21HX-U Duplex | 1331 | EN-GJL-250 |
| 16 | 1 | 706206 | R707-209-GG | Bearing housing cover | IEC132/180 | P4001 | EN-GJL-250 |
| 18 | 1 | 706246 | R707-084-ST | Distance ring | IEC100-180 | | S235JR |
| 35 | 1 | 706234 | R716-071-RV | Oil tank | | | AISI 304 |
| 36 | 1 | 706210 | R716-086 | Filling plug | | | |
| | 1 | 9B5320 | R756-137 | Plug | G 1" | | PA 66 |
| 39 | 1 | 706235 | R716-072 | Bracket | -H | | S235JR |
| 41 | 2 | 706233 | R716-043 | Coupling | RIK 8x1/4" | | CuZn 40 |
| 42 | 2 | 706233 | R716-043 | Coupling | RIK 8x1/4" | | CuZn 40 |
| 43 | 2 | 9M5530 | R716-031 | Pipe | Ø8 L=100mm | | Cu |
| 45 | 2 | 9B4423 | R754-141 | Hexagon socket screw | M 6 x 20 | | AISI 316 |
| 46 | 2 | 9B4423 | R754-141 | Hexagon socket screw | M 6 x 20 | | AISI 316 |
| 47 | 2 | 9B4722 | R758-088 | Lock washer | (M 6) | | AISI 316 |
| 48 | 2 | 9B3803 | R755-077 | Nut | M 6 | | AISI 316 |
| 49 | 1 | 706280 | R716-091 | Pipe nipple | R1/4"x100 | | Fe galv. |
| 50 | 1 | 9F2502 | R716-092 | Socket | R1/4" | | Fe galv. |
| 51 | 1 | 9B5420 | R756-139 | Plug | R 1/4" | | AISI 316 |
| 56 | 1 | 77256Z | R713-259-RZ | Data plate | Blanco 87x45x1 | | |
| 60 | 1 | 9D1320 | R751-207 | O-ring | 66x 3.00 | | NBR |
| 66 | 1 | 9B1850 | R752-006 | Circlip | A 50x2 | | spring steel |
| 67 | 1 | 9B1850 | R752-006 | Circlip | A 50x2 | | spring steel |
| 68 | 1 | 9B1870 | R752-033 | Circlip | J110x4 | | spring steel |
| 69 | 1 | 9B1835 | R752-004 | Circlip | A 35x1.5 | | spring steel |
| 74 | 8 | 9B4454 | R754-164 | Hexagon socket screw | M12x 40 | | AISI 316 |
| 77 | 4 | 9B4451 | R754-183 | Hexagon socket screw | M12x 25 | | AISI 316 |
| 78 | 4 | 9B4451 | R754-183 | Hexagon socket screw | M12x 25 | | AISI 316 |
| 82 | 1 | 9B2332 | R756-012 | Key | 12x 8x50 | | AISI 316 |
| 83 | 1 | 9B2305 | R756-101 | Key | 6 x 6x20 | | AISI 316 |
| 87 | 4 | 9B4202 | R757-076 | Data plate rivet | 2.9x6.5 | | AISI 316 |
| 96 | 1 | 9S0033 | R906-069 | Oil | Shell Tellus 32 2 ltr | | |
| 101 | 1 | 76364U | R701-157-RU | Volute | BW20/21 8G NW 80 | P475U | AISI329 |
| 112 | 1 | 9B5311 | R756-132 | Plug | G 3/8" | | AISI 316 |
| 113 | 1 | 9B5312 | R756-123 | Plug | G 1/2" | | AISI 316 |
| 114 | 1 | 77083L | R756-147 | Seal ring | Ø17x24x2 plug G3/8" | | PTFE |
| 115 | 1 | 77082L | R756-148 | Seal ring | Ø21xØ27x2 (G1/2") | | PTFE |
| 118 | 1 | 9D1314 | R751-176-VI | O-ring | 249.3x 5.7 | | Viton |
| 124 | 4 | 9B4496 repl | R754-145 | Hexagon socket screw | M12x 60 | | |

| Pos | Qty | Part nr | Robot nr | Description | Pattern | Material |
|---|-----|---------------------|----------------|--------------------------------|--|----------|
| 140 | 1 | | R708-369-RZ | Impeller | RW4021/31/32 con30 | |
| | (1) | | R708-369-RZ-17 | Impeller | 178 RW4021/31/32 con30 | |
| | (1) | | R708-369-RZ-17 | Impeller | 176 RW4021/31/32 con30 | |
| | (1) | | R708-369-RZ-17 | Impeller | 170 RW4021/31/32 con30 | |
| | (1) | | R708-369-RZ-16 | Impeller | 165 RW4021/31/32 con30 | |
| | (1) | | R708-369-RZ-16 | Impeller | 160 RW4021/31/32 con30 | |
| | (1) | | R708-369-RZ-15 | Impeller | 155 RW4021/31/32 con30 | |
| | (1) | | R708-369-RZ-15 | Impeller | 150 RW4021/31/32 con30 | |
| | (1) | | R708-369-RZ-14 | Impeller | 145 RW4021/31/32 con30 | |
| | (1) | | R708-369-RZ-14 | Impeller | 140 RW4021/31/32 con30 | |
| | (1) | | R708-369-RZ-13 | Impeller | 135 RW4021/31/32 con30 | |
| | (1) | | R708-369-RZ-13 | Impeller | 130 RW4021/31/32 con30 | |
| | (1) | | R708-369-RZ-12 | Impeller | 125 RW4021/31/32 con30 | |
| | (1) | | R708-369-RZ-12 | Impeller | 120 RW4021/31/32 con30 | |
| | (1) | | R708-369-RZ-11 | Impeller | 110 RW4021/31/32 con30 | |
| 141 | 1 | 706261 | R713-226-RU | Impeller hubcap | ø30xø9x4 | AISI 329 |
| 145 | 1 | 706292 | R754-117 | Hex. sock. screw counter sunk. | M 8x 20 | AISI 316 |
| Supplement support horizontal installation | | | | | | |
| 230 | 1 | 76208S | R710-349-ST | Volute support | H hh225 | S235JR |
| | (1) | 706274 | R710-340-ST | Volute support | H (GP) hh225 | S235JR |
| 232 | 3 | 9B4440 repl | R754-092 | Hexagon socket screw | M10x 20 | |
| 240 | 1 | 706236 | R710-412-ST | Bearing housing support | BWP42 hh225 | S235JR |
| | (1) | 706277 | R710-413-ST | Bearing housing support | 40 (GP) hh225 | S235JR |
| 242 | 2 | 9B4452 repl | R754-099 | Hexagon socket screw | M12x 30 | |
| Supplement Found. plate, coupling and motor IEC132/160-2pole | | | | | | |
| 304 | (1) | 9T0702 | R710-335 | Coupling | J-Flex Spacer 110-IEC132S+M Ø 38/42 | |
| | (1) | 9T0703 | R710-336 | Coupling | J-Flex Spacer 150-IEC160M Ø 42/42 | |
| | (1) | 9T0700 | R710-337 | Coupling | J-Flex Spacer 190-IEC160L Ø 42/42 | |
| 305 | 1 | 76231S | R710-280-ST | Foundation plate | 1250x560x110 | S235JR |
| 309 | (1) | 76210S | R710-431-ST | Protecting hood | BW40/60/ BT40/60 L=325 IEC132 | S235JR |
| | (1) | 706295 | R710-436-ST | Protecting hood | BW40/60/ BT40/60 L=355 IEC160/200 | S235JR |
| 310 | 8 | 9B3905 | R758-097 | Washer | (M10) | AISI 316 |
| 312 | 4 | 9B3046 | R753-208 | Hexagon tap bolt | M10x 40 | AISI 316 |
| 313 | 4 | 9B3805 | R755-097 | Nut | M10 | AISI 316 |
| 314 | 1 | 9B4496 | R754-199 | Hexagon socket screw | M12x 60 | AISI 316 |
| 400 | (1) | 9T1552 | R790-008 | Motor | IEC132S 5.5 kW-2 voet B3 | |
| | (1) | IEC132S 7.5-2B3 | R790-009 | Motor | IEC132S 7.5 kW-2 voet B3 | |
| | (1) | IEC160M 11-2B3 | R790-010 | Motor | IEC160M 11 kW-2 voet B3 | |
| | (1) | IEC160M 15-2B3 | R790-011 | Motor | IEC160M 15kW-2 voet B3 | |
| | (1) | IEC160L 18.5-2B3 | R790-012 | Motor | IEC160L 18.5 kW-2 voet B3 | |
| 401 | (2) | 76211S | R710-284-ST | Motor support | IEC132 hh225 | S235JR |

| Pos | Qty | Part nr | Robot nr | Description | | Pattern | Material |
|------------------------------|-----|---------|---------------|----------------------|----------------------|---------|----------|
| 401 | (2) | 706294 | R710-286-ST | Motor support | IEC160 hh225 | | S235JR |
| Option: seal flushing | | | | | | | |
| 10 | 1 | 76238U | R704-188-RZ-F | Seal housing | BW/BD40 spoelw/flush | P588U | AISI 329 |
| 250 | 1 | 76239Z | R711-175-RZ | Baffle plate | BW40/BT20/4040 | | AISI 316 |
| 251 | 1 | 706232 | R716-029 | Pipe nipple | R3/8 x 150 | | AISI 316 |
| 252 | 3 | 9B4420 | R754-184 | Hexagon socket screw | M 6 x 12 | | AISI 316 |
| Option Sparepart kit | | | | | | | |
| 600 | 1 | 77884E | R506-7000 | Spare part kit | BW40-H/V/K BWP/BNP42 | | |

BW4021-H
BW4020-H

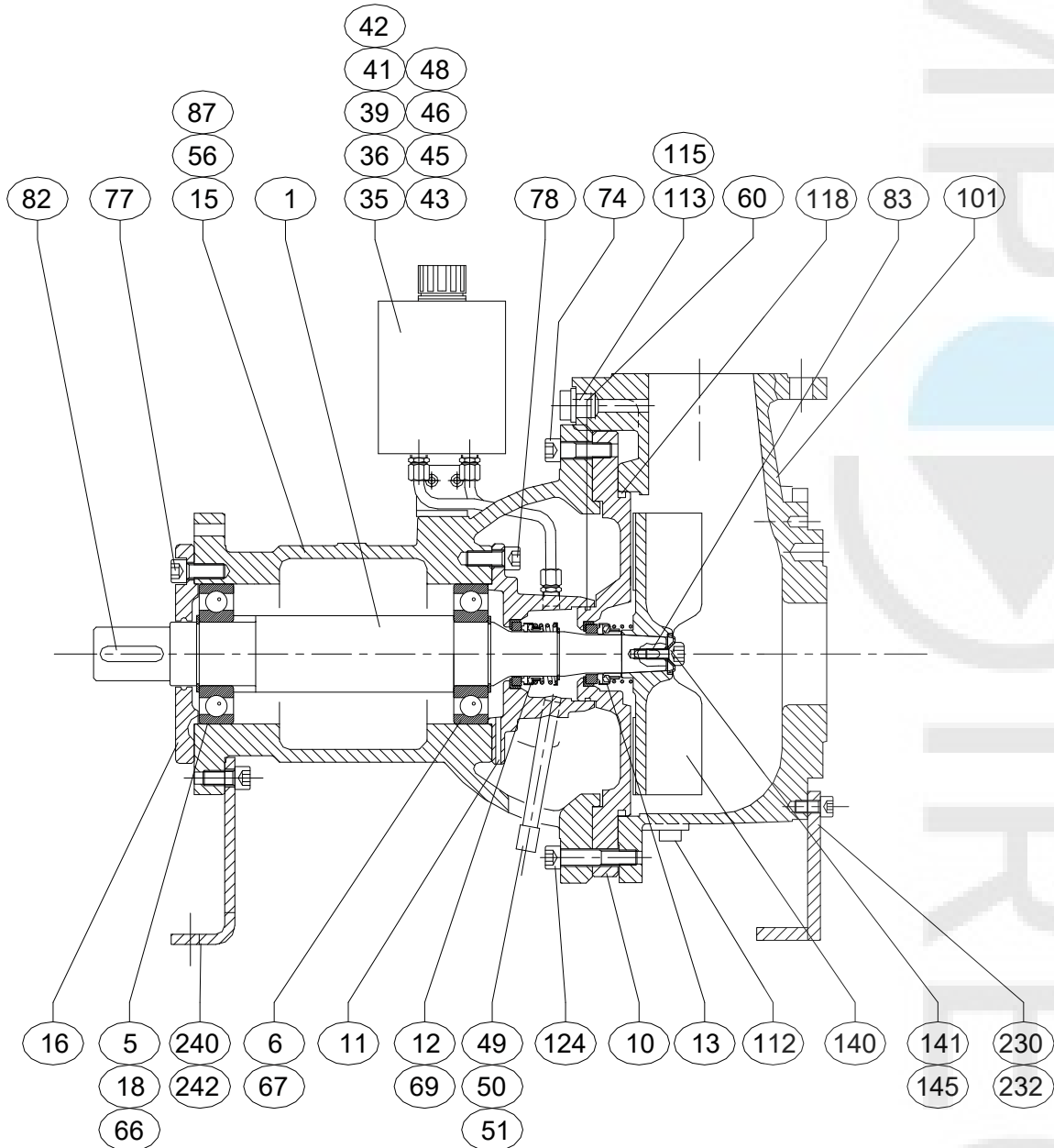

BW4021-H
BW4020-H

